

TRANSPORT DIRECTION

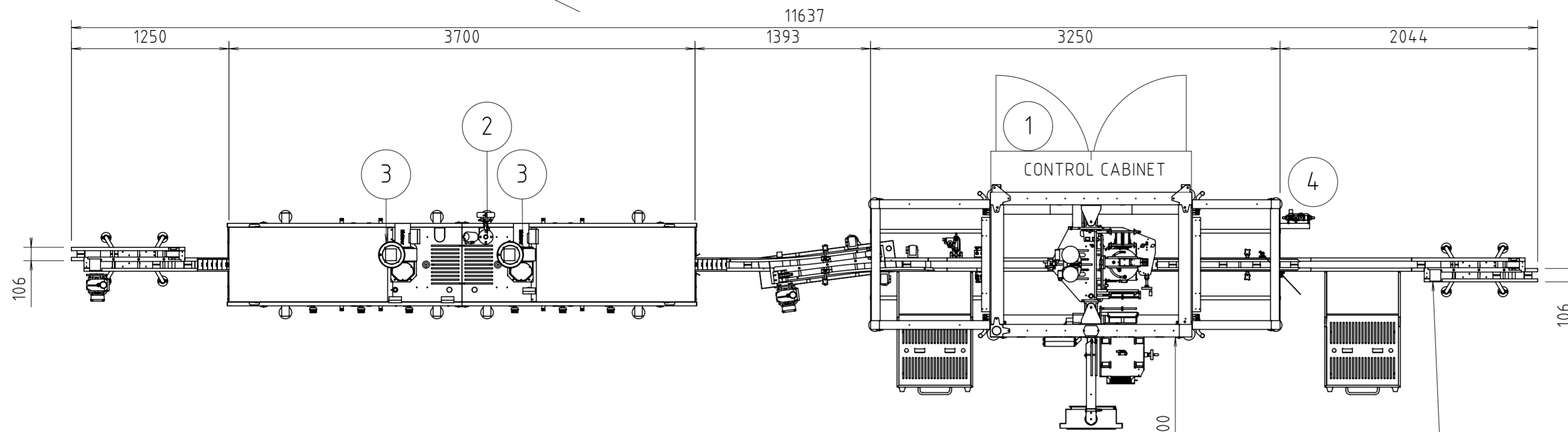

- 1 CONTROL CABINET
3x480V + N + PE 60Hz
Pmax 14kVa I_{max} 20A
- 2 STEAM SUPPLY 1" FEMALE
4 BAR CONTINUOUS
MAX 245Kg/H, ACTUAL +/-120Kg/H
- 3 STEAM EXHAUST ϕ 150x2
MAX 900Kg/H
- 4 AIR SUPPLY 1/4"
6 BAR
ACTUAL 5L/min
- 5 WATER DRAIN ϕ 40

CHAIN: REXNORD SHP325XL
MOTOR REDUCER: SEW SAF47 DRN80M4

MOTOR ON THIS TRANSITION SUPPLIED AND CONTROLLED BY MULTIPACK

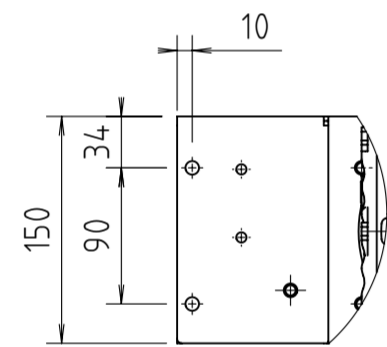

DETAIL A
(1 : 5)

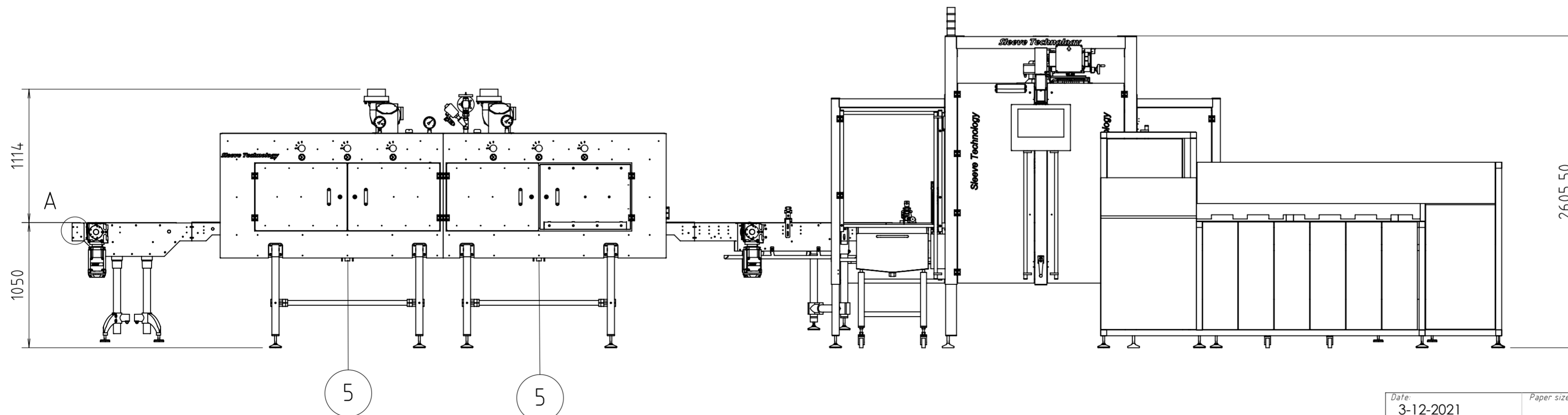
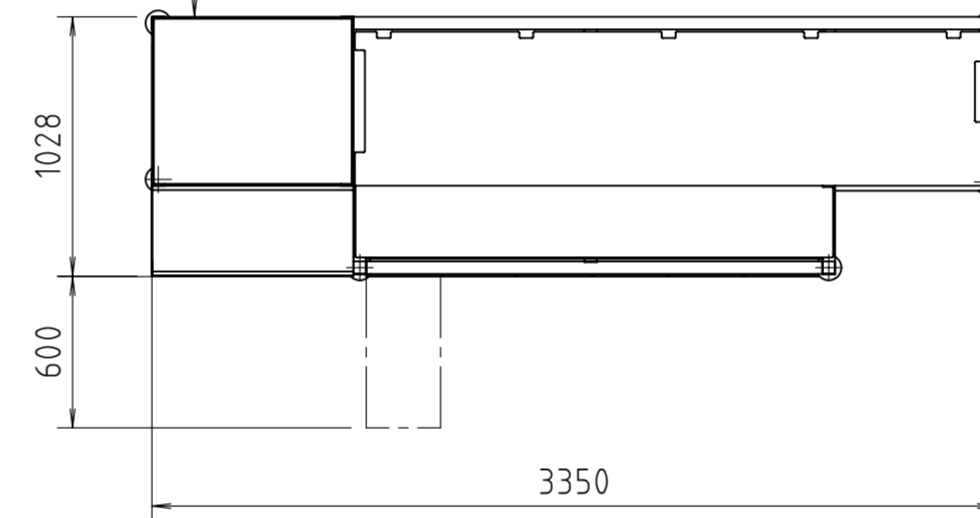

Date: 3-12-2021	Paper size: A2	Material:
Engineer: R. van Dam	SCALE:1:30	Finish:
Break edges: 		Title: HSSA1600 + HSS600 + CR6-180
Geometric tolerancing: ISO 1101 Surface texture: ISO-1302 Standard roughness: 	Linear dimensions: ± 0.3 Angular dimensions: $\pm 1^\circ$ Hole diameters: $0/+0.3$	DWG No: 117.000.000
 Sleeve Technology www.sleeve-technology.com <small>all rights reserved</small>		Revision: